



engineered
for Efficiency

designed
for Comfort

equipped
with Peace
of Mind

6577 N Sidney Place, Glendale, WI 53209
888-815-7757 • 414-377-0222

www.myfusionspa.com • info@myfusionspa.com

Fusion Spas Luna Spa Owner's Manual

The information contained herein is true and correct at time of printing. We reserve the right to update this document at any time.



engineered
for Efficiency

designed
for Comfort

equipped
with Peace
of Mind

Luna Spa Owner's Manual

Read thoroughly before
installation and use.

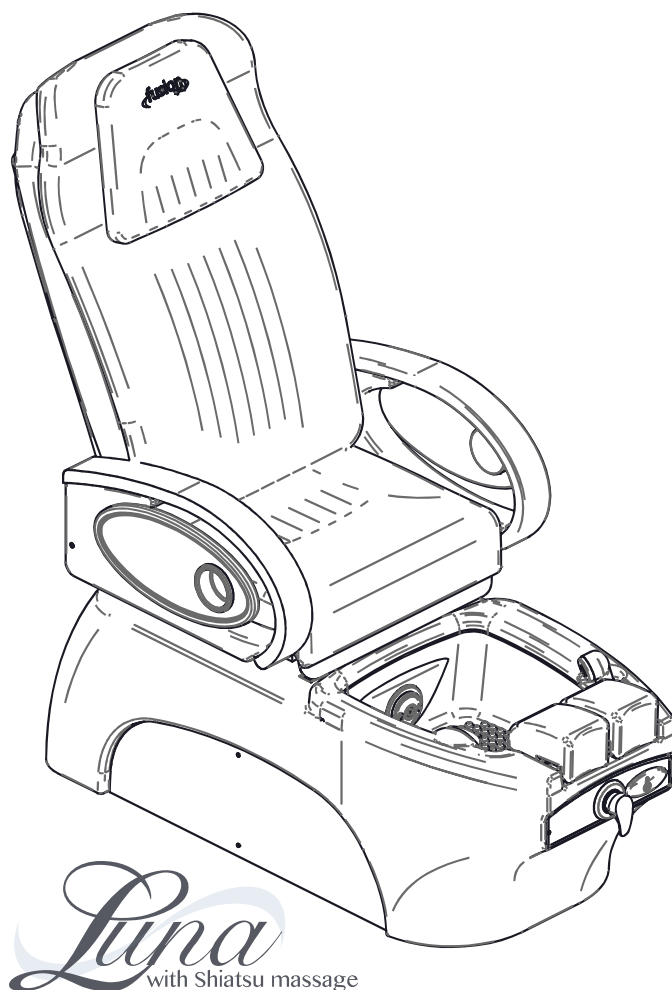
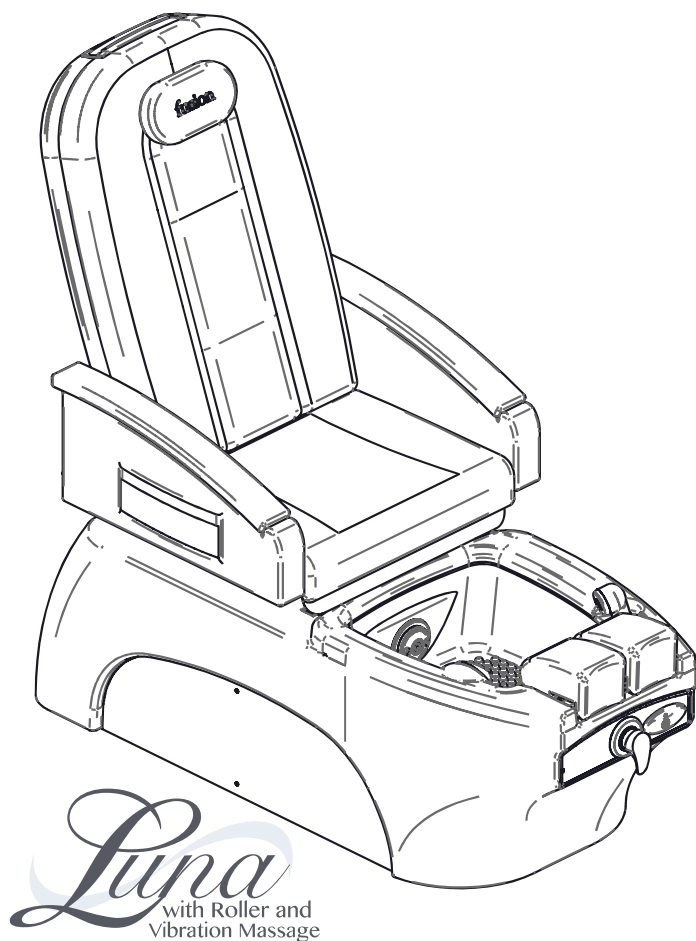

Certifications



Exceeding Industry Standards

Luna

Fusion Spas

888-815-7757

Model: **Luna Spa** Serial # **XXXX/X**

Electrical Rating: 120V, 60Hz, 7.5A, 900w

Conforms to UL STD 1951

Certified to CAN/CSA Std C22.2 No. 68

Also classified in accordance with:

ASME A112.18.3-2002(R2008)

ASME A112.18.1-2012/CSA B125.1-12



Intertek

5000461

JAN FEB MAR APR MAY JUN JUL AUG SEP OCT NOV DEC
2015 2016 2017 2018 2019 2020

6577 N Sidney Place, Glendale, WI 53209
888-815-7757 • 414-377-0222

www.myfusionspa.com • info@myfusionspa.com

Fusion Spas Luna Spa Owner's Manual

The information contained herein is true and correct at time of printing. We reserve the right to update this document at any time.

Table of Contents

3	Introduction How to Use this Manual Important Information	Selecting a Location	13
4	Safety & Precautions	Installation Drawings & Instructions Luna Spa with Roller & Vibration Massage	14
5	Health Risk Warning Preventing Bodily Harm	Installation Drawings & Instructions Luna Spa with Shiatsu Massage	15
6	Unpacking and Assembly of your Pedicure Spa	Luna Spa Parts Breakdown	16
7	Assembly and removal of side panels—Anchoring Spa	Luna Spa Technician Controls	18
8	Getting Acquainted with your Spa Luna Spa with Roller & Vibration Massage	Basic Use of Your Luna Spa	19
9	Getting Acquainted with your Spa Luna Spa with Shiatsu Massage Upgrade	Client Controls	20
10	Installation & Utility Information Electrical Service Water supply	Cleaning & Disinfecting Procedures	22
11	Water Supply & Grounding Instructions	Limited Conditional Warranty	24
12	Luna Spa Specifications		



Introduction

Thank you for selecting Fusion Spas, the designer, manufacturer, and marketer of the Luna Spa (herein referred to as spa).

How to use this Manual

We've created this manual to use in tandem with your pedicure spa to ensure trouble-free use with full understanding of your spa's features. Illustrations complement the text to best explain the use of your spa. By reading and becoming familiar with this Manual, you can learn your spa's features, important safety information, and installation details. Please keep this manual for the life of the spa, as it is your tool to understanding every feature of your spa.

If you have any questions regarding your spa, please contact Fusion Spas at 1-888-815-7757, Monday through Friday 8 AM to 5 PM Central Time.

Important Information

Serial Number: _____

Installed by: _____

Installation Date: _____

*The serial number is located near the water connections on the back of the spa.

Fusion Spas requires that you contact a local, licensed plumber and licensed electrician to install your new pedicure spa. Installation must be in compliance with all local and state building codes. Your pedicure spa cannot operate efficiently or safely unless it is provided with adequate electrical power, sufficient water pressure, proper water temperature, and required drainage capabilities. Contact your local building inspector for information and local code compliance procedures that need to be followed when having your pedicure spa installed. Subsequent inspections and approvals that may be required are the responsibility of the purchaser. See limited warranty regarding incidental or consequential exclusions on Page 24 of this manual.

Safety & Precautions

To reduce electric shock risk to minimum:

- Remember to unplug the power after each use.
- Remember to unplug the power before cleaning.

To reduce the risk of burning damage, fire, electric shock, or bodily harm:

- Before using the chair, make sure to uncover back pad to check if there are any tears or holes in the cloth. If tears or holes are found, stop using immediately and contact Fusion Spas.
- This item should only be operated according to this manual.
- Please don't stand on the chair or in the basin of the pedicure spa.
- Please remember to unplug the chair when not in use. Please stop all the massage functions before unplugging the chair.
- If the supplied cord is damaged, it must be replaced with an OEM component from Fusion Spas. Never operate spa or massage function if power cord becomes damaged or dropped into water.
- If the chair becomes damaged or fails to operate, please contact Fusion Spas.
- To avoid electric shock or bodily harm, please don't open or disassemble any part of this spa while plugged in. Unplug spa from wall before attempting any repairs.

CAUTION

When using an electrical appliance, basic precautions should always be followed, including the following:

To reduce the risk of burns, fire, electrical shock or injury to persons:

- Read all instructions before using pedicure spa.
- Save these instructions for future reference.
- Use the pedicure spa only for its intended use as described in this manual. Do not use attachments not recommended by Fusion Spas.
- Excessive water temperature is dangerous and should be checked before use.
- Maximum operating water temperature should not exceed 105° F (41° C) and the maximum supply water temperature should not exceed 120°F (49° C).
- Always verify maximum temperatures with your local and state codes.
- Always enter and exit the pedicure spa slowly and carefully.
- Never bring or operate any electrical devices into or near the pedicure spa.
- Close side arm rests before operating the chair seat movement.
- Use only while seated.
- Keep children away from extended leg support.
- Connect this appliance to a properly grounded outlet only. See Grounding Instructions within this manual, page 11. Keep the wall outlet accessible after installation.
- Test the ground fault circuit interrupter (GFCI) protecting this appliance periodically in accordance with these instructions.
- This pedicure spa has a weight capacity of 350 pounds (113.4kg).
- Do not operate where aerosol (spray) products are being used or where oxygen is being administered.

Health Risk Warning



IMPORTANT

Individuals whose feet or legs are inflamed or have open wounds should not be allowed to use the pedicure spa at any time. Nail technicians should advise clients to consult their physician before using the pedicure spa if there is any sign of fungal infection, swelling, fracture, or persistent pain. In some cases diabetics may experience improved circulation in their feet, but should first consult their physician prior to receiving a pedicure. If the client experiences any pain or discomfort, immediately discontinue the use of the pedicure spa.

Your client's massage and pedicure spa experience should be pleasant and comfortable.

Preventing Bodily Harm



IMPORTANT

- Disabled people or those who can't express themselves must be strictly and continuously supervised while using this spa.
- Pregnant women, people of poor health and those who feel pain in their neck, waist or hip should consult their doctor before use. People with heart pacemakers or other personal medical devices should contact their personal doctor before use.
- Please do not allow children to use or play near pedicure spa.
- Don't put any part of your body between the rollers, otherwise roller massage action may cause harm. Also, do not put hands or feet into the gap between the back and seat, back and armrest or any other active parts to avoid bodily injury. Never insert any object into any opening. Avoid dropping any items into any opening.
- Do not use massage mechanism against bare skin. Skin irritation may result.
- Do not massage the head, belly, elbow or knees. Please be cautious when massaging shoulder areas.
- To avoid discomfort, ensure your client's neck is comfortable. Adjust the neck pillow accordingly.
- Maximum massage time is 20 minutes (massage functions turn off automatically after 20 minutes).
- If your client feels nausea or pain during the massage, please stop the massage by pressing the STOP key at any time.
- When back of chair is in a reclined position, please don't sit on the seat back or press heavily on it.
- Don't allow children or pets to play near or on the spa - especially during massage.
- If power problems occur, please unplug the power immediately.
- Do not use outdoors.

Unpacking & Assembly of your Pedicure Spa

As you unpack your spa, take note to ensure the following items are included:

- Seat bottom cushion
- Head pillow
- Remote control
- If equipped with Shiatsu Massage, a back pad will also be included in the shipping carton.

If you notice an item missing, please contact Fusion Spas immediately to have the situation remedied.

Upon unpacking your Spa, some assembly is necessary. Two people are required for installation and setup of your spa.

1. Locate and remove the hitch and cotter pin from the recline actuator.
2. Pivot the backrest into upright position making sure to line up the holes in the backrest bracket with the holes in the actuator.
3. Replace the previously removed hitch pin through the bracket and actuator and secure with cotter pin.

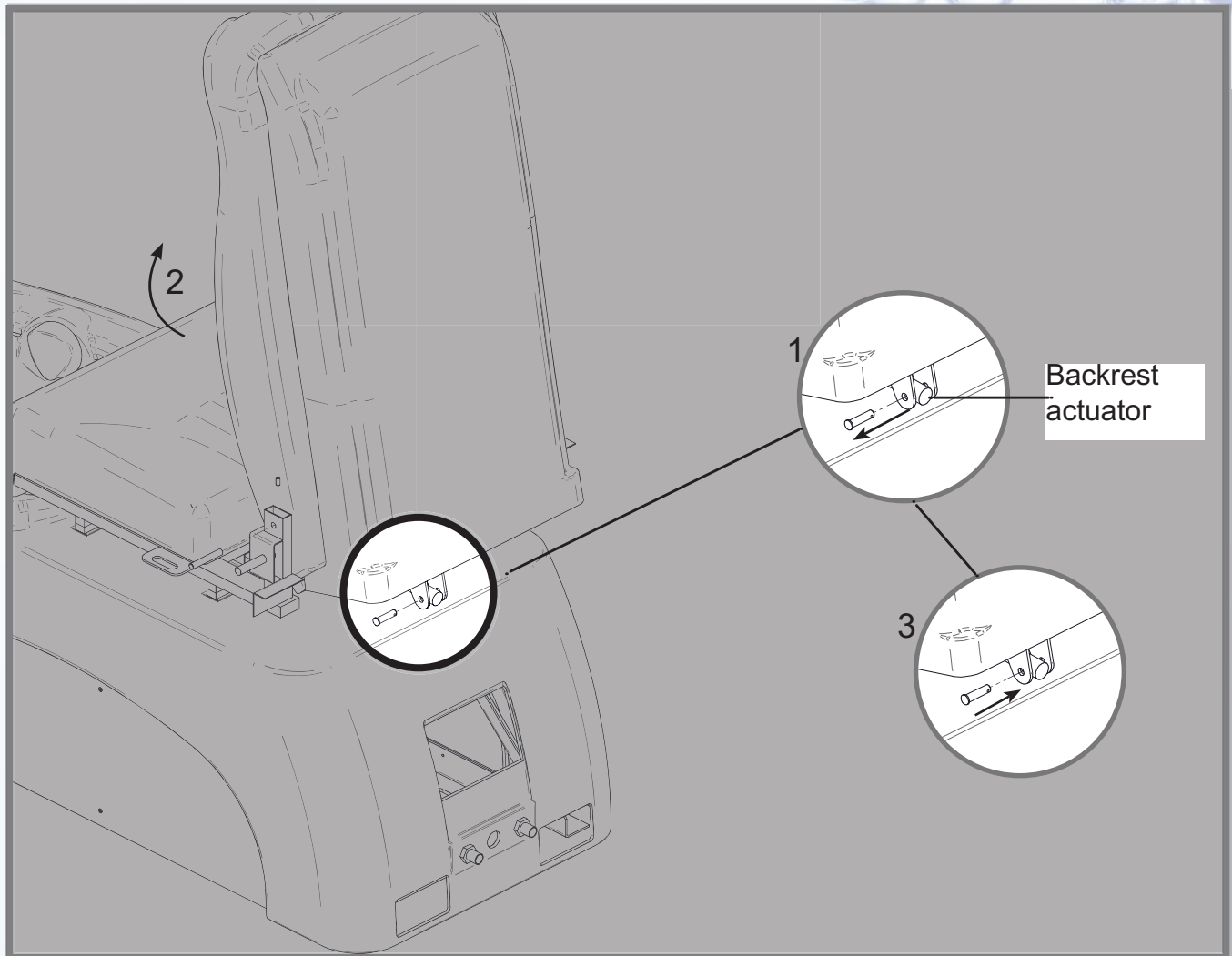

Assembly and Removal of Side Panels

Required for Anchoring Spa

Warning: Side panels must be removed prior to installing or moving Luna Spa

1. Remove the two screws on each panel.
2. Remove the side panels.
3. Anchor spa to the floor where indicated.
4. Reattach the panels by reversing these steps.

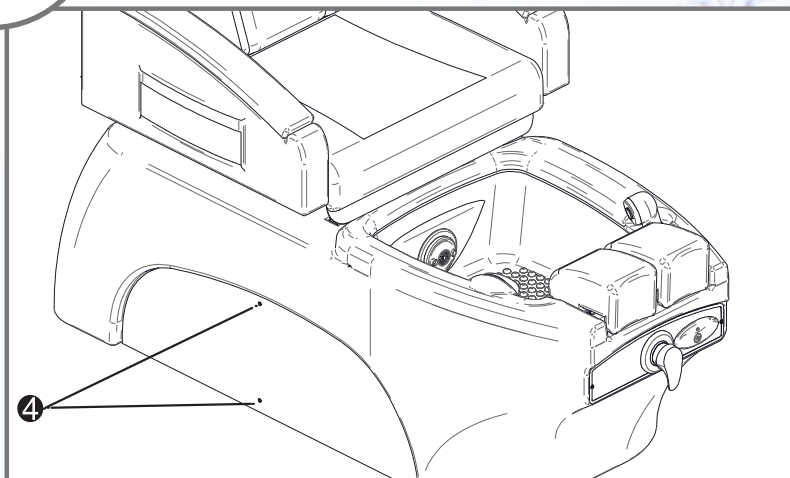
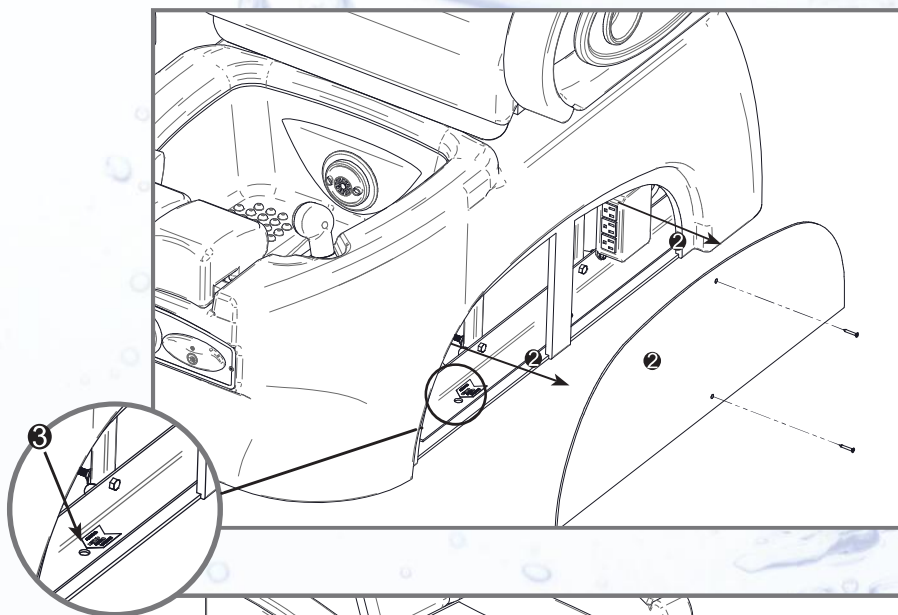
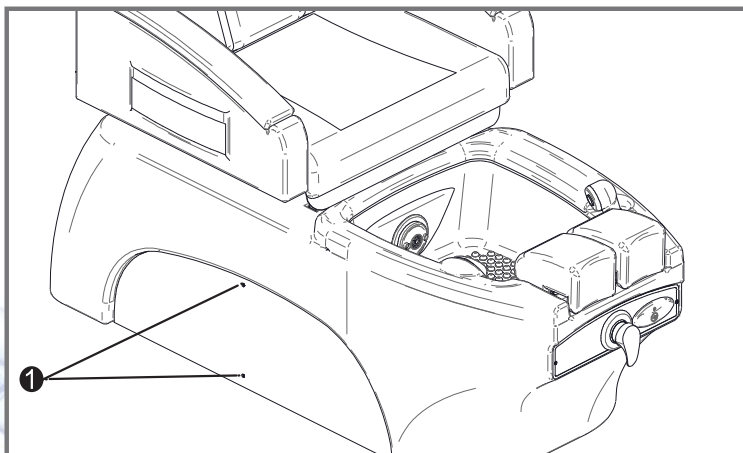

Getting Acquainted with Your Spa

Luna
with Roller and
Vibration Massage

- 1 Adjustable neck pillow
- 2 Arm rest
- 3 Basin fill line
- 4 Purely Simple Water Movement Assembly
- 5 Sprayer/Fill Spout
- 6 Adjustable client leg support
- 7 On/Off button
- 8 Faucet control
- 9 Drain pop-up knob
- 10 Removable side panels
- 11 Remote control pocket

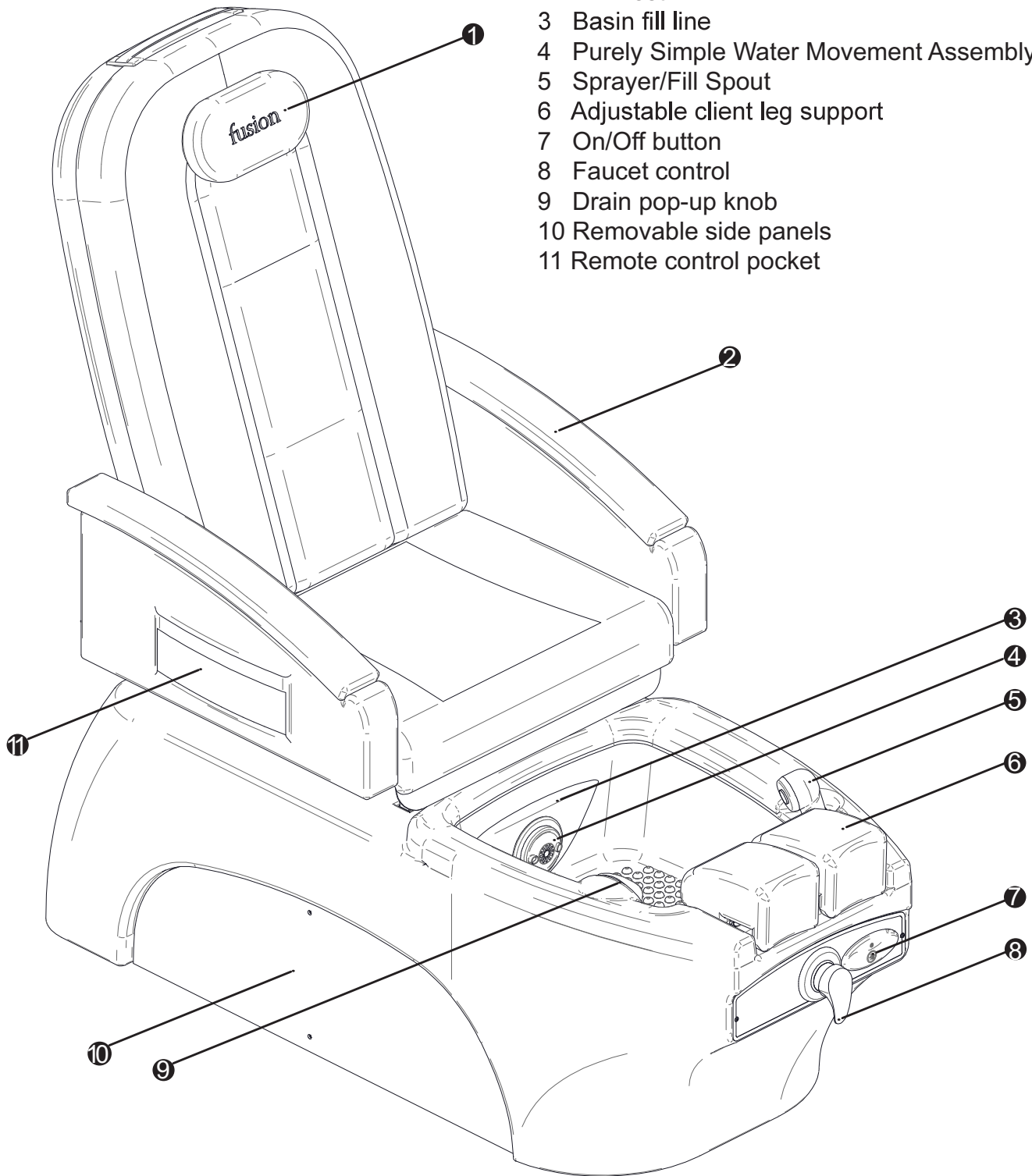

Getting Acquainted with Your Spa

Luna
with Shiatsu massage

- 1 Adjustable neck pillow
- 2 Arm rest
- 3 Basin fill line
- 4 Purely Simple Water Movement Assembly
- 5 Sprayer/Fill Spout
- 6 Adjustable client leg support
- 7 On/Off button
- 8 Faucet control
- 9 Drain pop-up knob
- 10 Removable side panels
- 11 Client cup holder
- 12 Flip up manicure trays

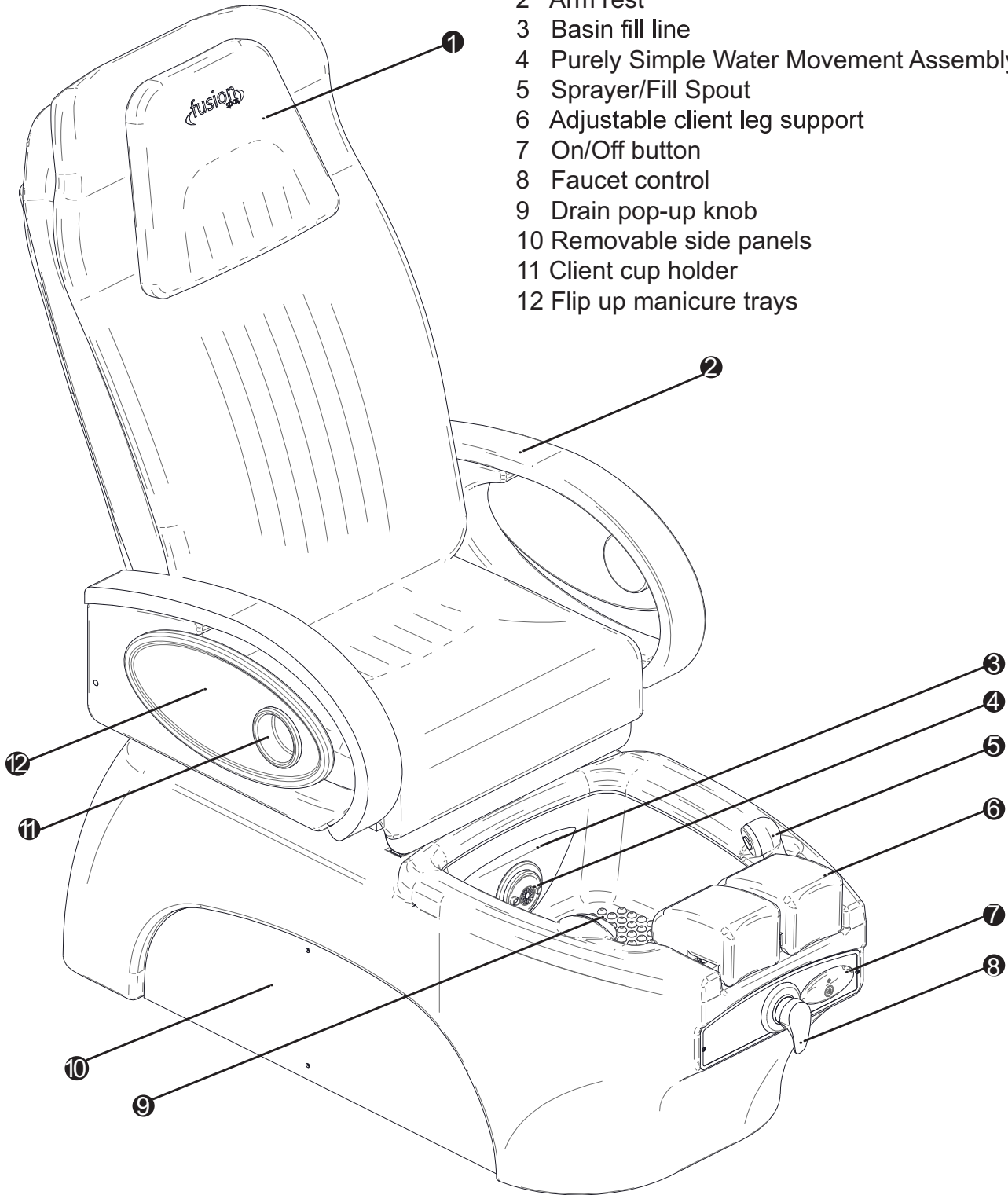

Electrical Service

120V, 60 Hz, 7.5 Amp, 900W GFCI protected grounded circuit must be used to supply power to the pedicure spa.

Water Supply

- All plumbing connections must conform to local codes.
- Water pressure must be 30 to 80 PSI for the sprayer to operate correctly.
- Maximum operating water temperature should not exceed 105° F (41° C) and the maximum supply water temperature should not exceed 120° F (49° C). (In Massachusetts, the maximum supply water temperature should not exceed 130° F (54° C)). Adjust the hot water heater accordingly.
- For hot and cold water supply fittings and power drain fittings location, see illustrations below.
- Carefully connect the incoming water supply lines to the appropriate fittings located on the back of the pedicure spa. Shut-off valves are recommended.
- The pedicure spa drain must meet local plumbing codes. (Pedicure Spa must be installed by a licensed plumber.)
- **Note:** See local and state codes as to what type of drain connection is required to be made.
- Check your Local & State plumbing codes for additional backflow requirements. Any additional requirements are the responsibility of the owner of the unit.
- Backflow Protection Devices for Faucets with Side Spray: Check valves comply with ANSI/ASME A112.18.3M, A112.18.1M, and CSA B12.
- Faucet body contains Neoperl® DW15GF and CV15-FR check valves. See Faucet illustration on page 11 for further detail.
- The drain line must be a minimum of 3/4" inside diameter from Spa to wall connection for basin to drain properly.

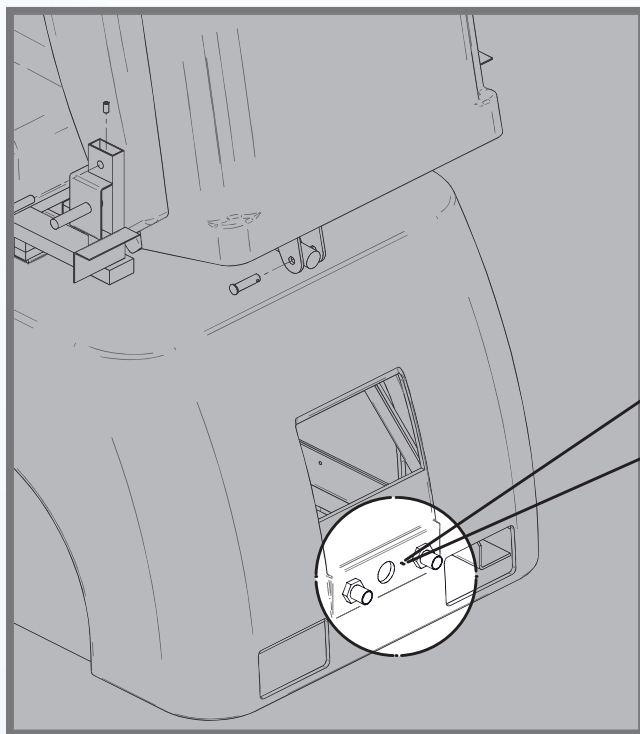

Not equipped with Power Drain Pump

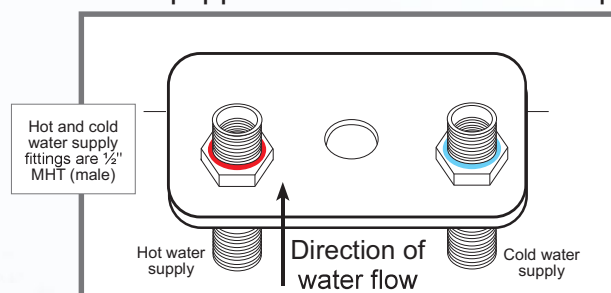

Equipped with Power Drain Pump

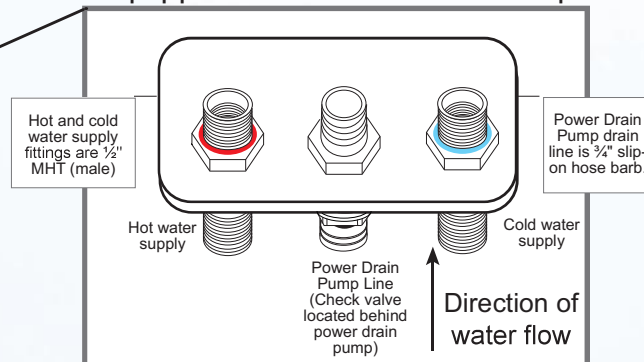

Water Supply

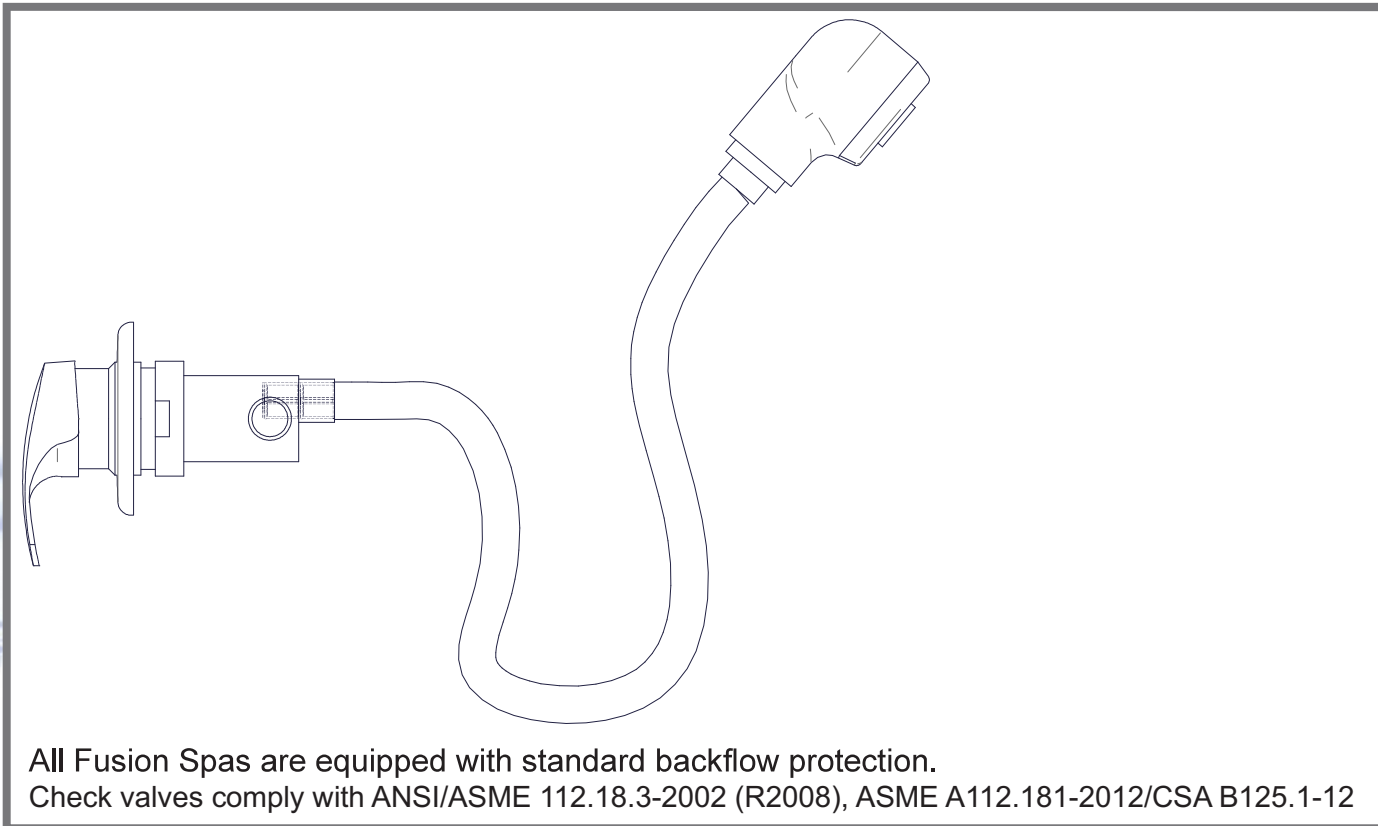

All Fusion Spas are equipped with standard backflow protection.
Check valves comply with ANSI/ASME 112.18.3-2002 (R2008), ASME A112.181-2012/CSA B125.1-12

Grounding Instructions



When using electrical products, basic precautions should always be followed, including the following:

Risk of Electric Shock: Connect only to a circuit protected by a ground-fault circuit interrupter outlet (GFCI). The unit should be installed by a qualified service representative and grounding is required.

This unit must be grounded. If it should malfunction, grounding provides a path of least resistance for electric current to reduce the risk of electric shock. This product is equipped with a cord having an equipment-grounding conductor and a grounding plug. The plug must be plugged into an appropriate outlet that is properly installed and grounded in accordance with all local codes and ordinances.

Improper connection of the equipment-grounding conductor can result in a risk of electric shock. Check with a qualified electrician or service person if there is doubt as to whether the product is properly grounded. Do not modify the plug provided with the product - if it will not fit the outlet, have a proper outlet installed by a qualified electrician.

This product is for use on a standard 120-V circuit and has a polarized grounding plug that looks like this. Note one prong is larger than the other to fit in a GFCI electrical outlet properly.

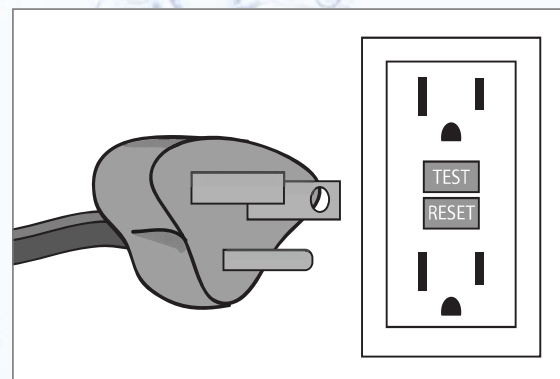

Specifications

- Hot and cold water supply lines required (hot and cold shut offs may be installed under pedicure spa base).
- Pedicure spa must be installed by a licensed electrician and a licensed plumber, conforming to all local and national electrical and plumbing codes.

All dimensions and weights are approximate.

SPA INFORMATION

- Whirlpool pump motor: 120V / 60HZ / 1Amp
- Water Fill Line Capacity: 5.5 U.S. gallons (21 Liters)
- Seat upholstery: Polyurethane
- Seat and back motors: 24V DC Linear Actuators.
- Power source: 120V / 60HZ / 7.5Amp / 900W
- Construction: Low Density Polyethylene (LLDPE), self-contained, pre-plumbed, Steel Frame, pre-plumbed
- Technology: 2 water massage channels, no closed loop circulating pipes, fully drained. System employs three part assembly that twists from the basin for easy cleaning.
- Electrical switches: On/Off switch for pump. Single hand-held, low voltage remote controls for massage motors and seat forward/back position.
- Hot and Cold water supply lines required.
- Compliances: Conforms to UL STD 1951. Certified to CAN/CSA Std C22.2 No. 68
Also classified in accordance with: ASME A112.18.3-2002(R2008) ASME A112.18.1-2012/CSA B125.1-12
- Electrostatic Limits: This unit may lose one or more functions when electrostatic contact discharge in excess of 4KV gets into accessible conductive part of the unit and can be restored by resetting the unit. AC input power port and can be restored by resetting the unit. This unit may lose one or more functions when subjected to fast transient voltages in excess of 0.5KV at 5 KHz repetition frequency and cannot be restored.
- Limited warranty: See page 24 for full warranty information.

SHIPPING INFORMATION

Luna Spa with Roller Massage (Model FS2013RM-WI)

Shipping Dimensions (spa only with seat collapsed): 56"L (142cm) x 29"W (74cm) x 34"H (86cm)

Shipping Dimensions
(spa with seat collapsed, carton, and pallet): 67"L (170cm) x 38"W (100cm) x 43"H (109cm)

Weight: 175 lbs. (91 kg) - Spa
225 lbs. (114 kg) - Spa, carton, and pallet

Overall dimensions, seat upright and forward: 56"L (142cm) x 29"W (74cm) x 56"H (142cm)

Minimum area required for full chair movement: 68"L (173cm) x 33"W (84cm) x 60"H (152cm)

Spa requires 13" (34.29 cm) of space between pedicure spa and wall

Luna Spa with Shiatsu Massage (Model FS2013FB-WI)

Shipping Dimensions (spa only with seat collapsed) 56"L (142cm) x 32"W (82cm) x 34"H (86cm)

Shipping Dimensions
(Spa with seat collapsed, carton, and pallet): 67"L (170cm) x 38"W (100cm) x 43"H (109cm)

Weight: 200 lbs. (91 kg) - Spa
250 lbs. (114 kg) - Spa, carton, and pallet

Overall dimensions, seat upright and forward 59"L (150cm) x 32"W (82cm) x 56"H (142cm)

Minimum area required for full chair movement 75"L (191cm) x 50"W (127cm) x 60"H (152cm)

Spa requires 19.5" (49.53 cm) of space between pedicure spa and wall

NOTE: Due to our policy of continuous improvements, all specifications are subject to change without notice.

Selecting a Location

For your spa to work properly, the floor underneath must be level and the structure below must be capable of supporting the occupied unit.

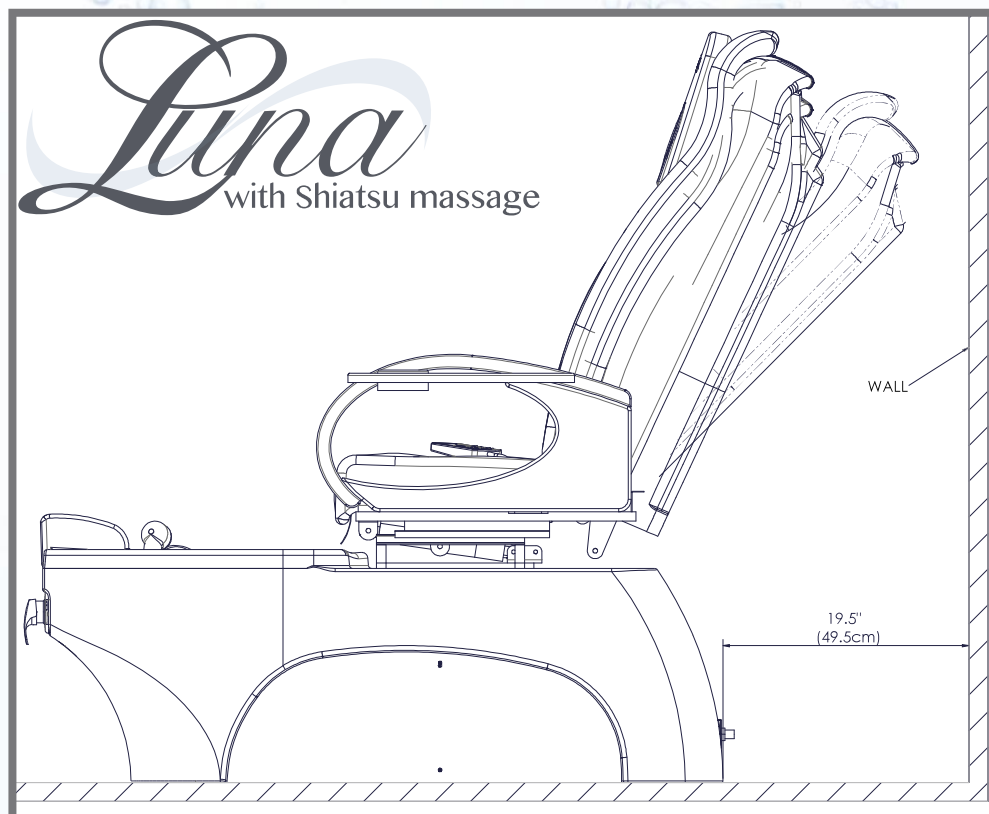
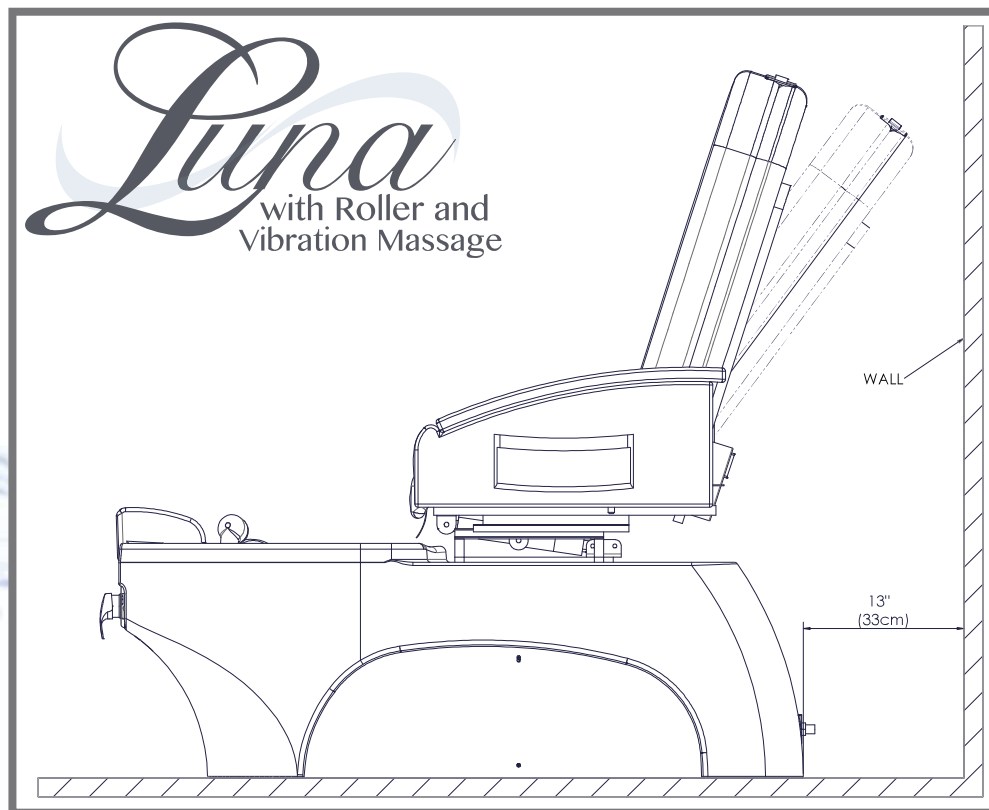

Luna Spa Installation Drawings & Instructions



Note: Cutting end off of electrical plug to hard wire the spa is not recommended and doing so will void the warranty.

LOCATE FLOOR DRAIN
WITHIN REAR CUTOUT

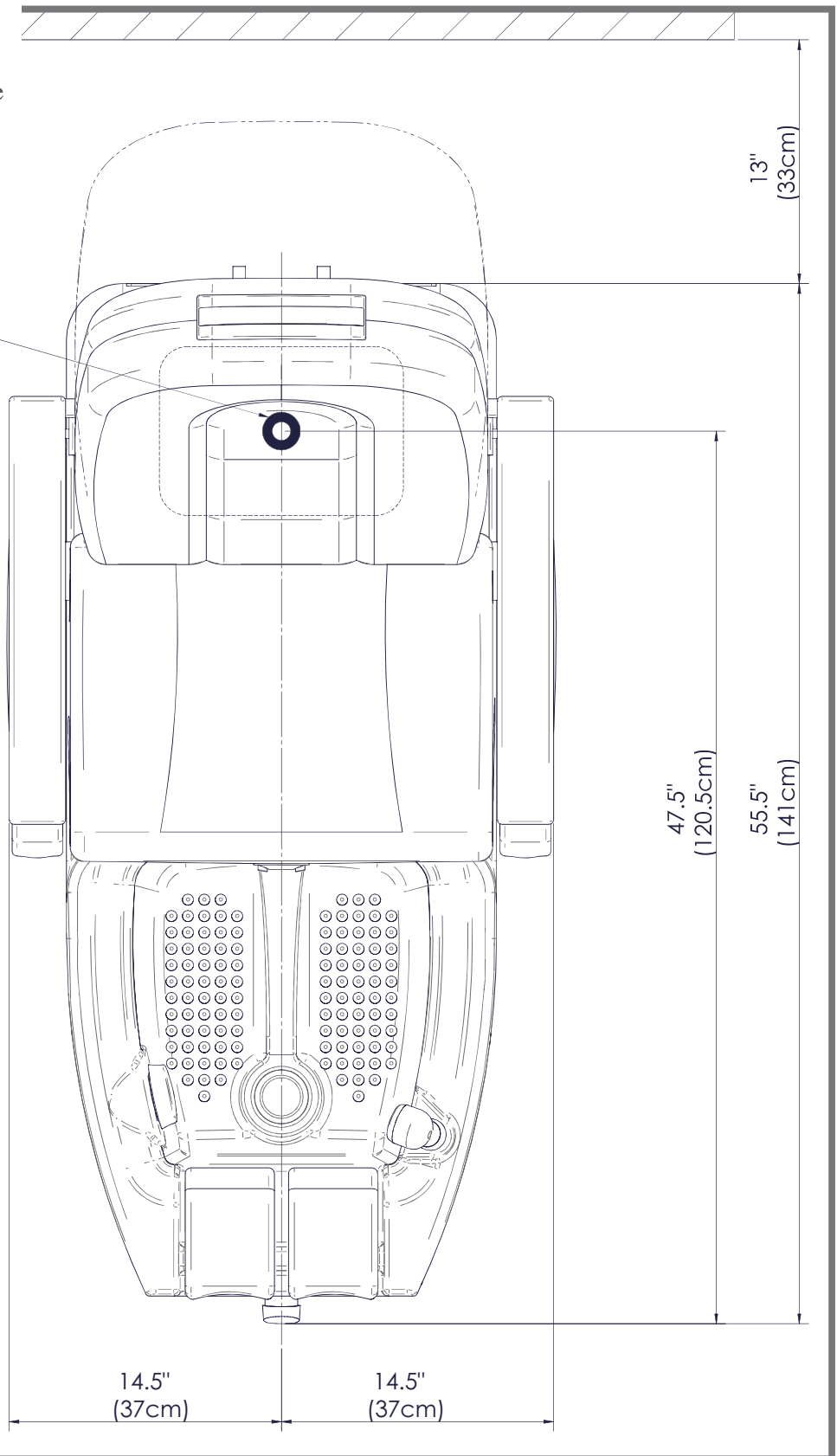

Luna Spa Installation Drawings & Instructions



Note: Cutting end off of electrical plug to hard wire the spa is not recommended and doing so will void the warranty.

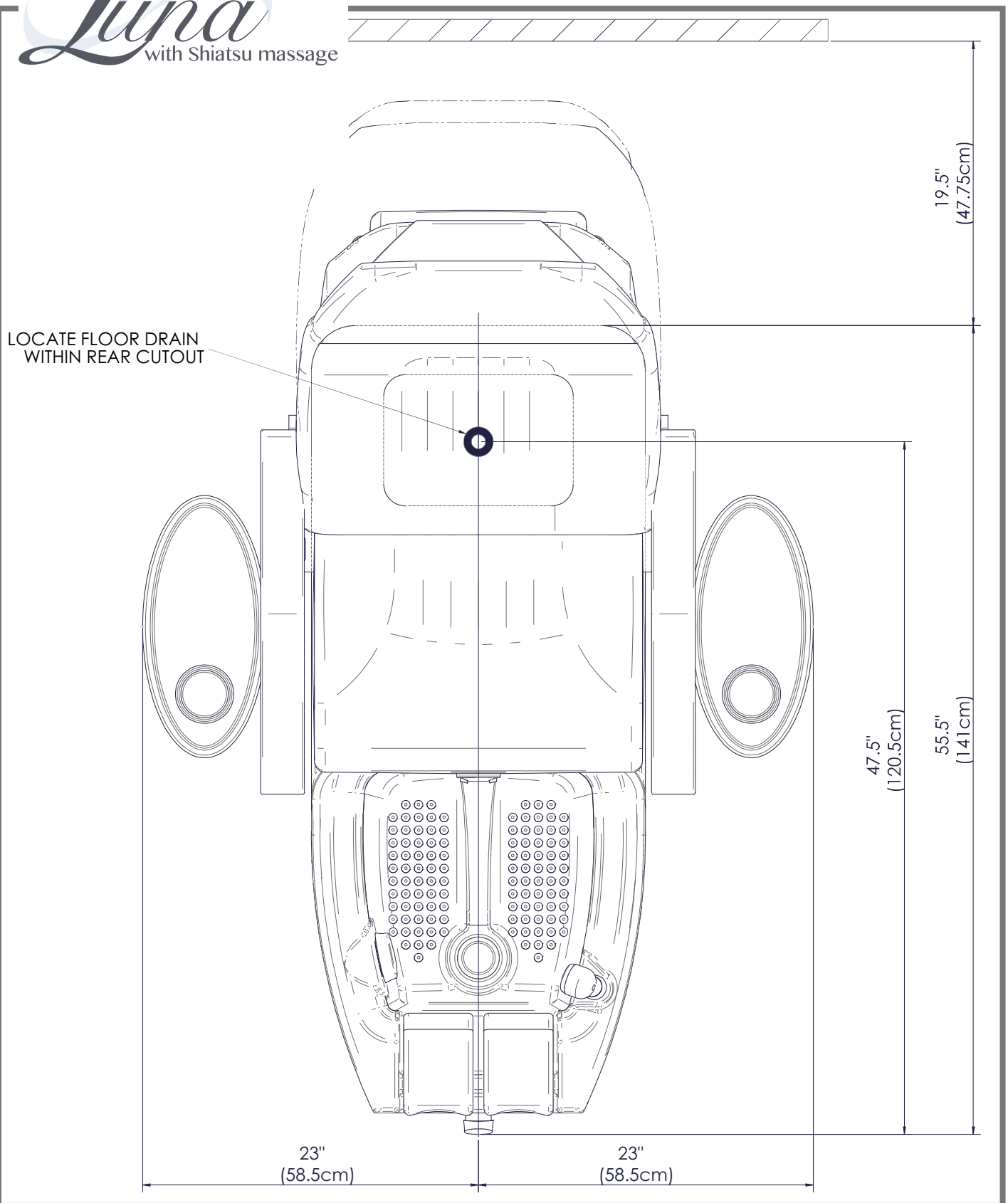

Luna Spa Part Breakdown

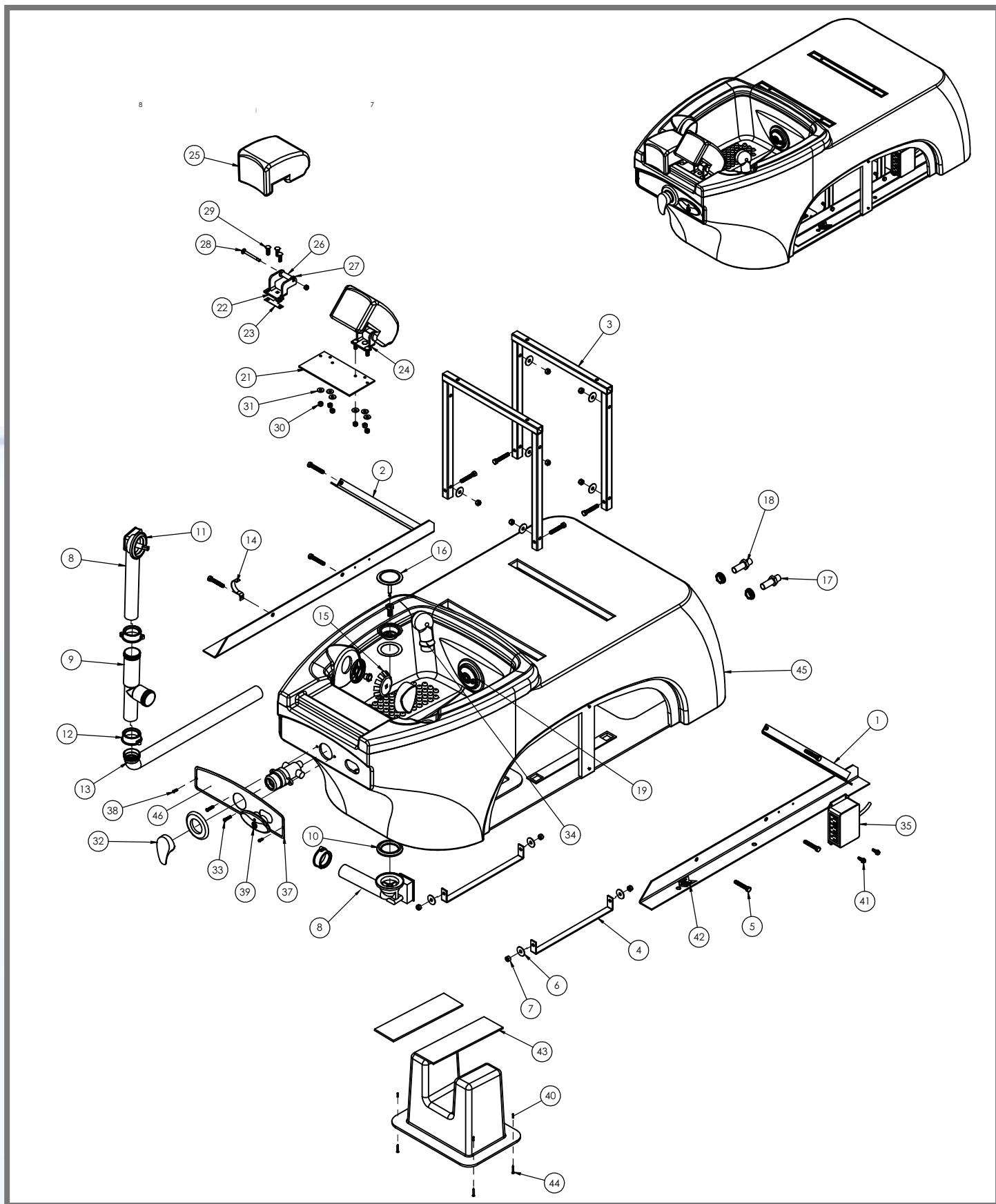

Luna Spa Part Breakdown

Description Part Number

1	Seat Stabilizer Left	2000005
2	Seat Stabilizer Right	2000006
3	U Frame Seat Support	2000004
4	Lower Frame Bracket	2000002
5	5/16" - 18 Bolt	910011
6	5/16" Washer	910012
7	5/16" Lock Nut	910003
8	Waste Shoe	1000200
9	Waste Tee	1000201
10	Waste Shoe Gasket	1000202
11	Waste Shoe Gasket Upper	1000210

Description

Part Number

12	Waste Shoe Nut	1000203
13	Waste Arm 20"	1000211
14	Waste Arm Support Bracket	2000009
15	Drain Handle Set	1000205
16	Waste Plunger and Strainer	1000206
17	Cold Water Bulkhead	1000208
18	Hot Water Bulkhead	1000209
19	Pipe-Free Motor Assembly	1000010
20	Clear Hose*	1000216
21	Footrest Support Plate	2000003
22	Footrest Assembly Bracket (lower)	1000218
23	Footrest Bracket Gasket	1000223

*Item #20 not shown

Description Part Number

24	Footrest Assembly Bracket Upper	1000225
25	Footrest	1000222
26	Footrest Swivel Spacer	1000215
27	Nylon Washer	910014
28	Carriage Bolt	910007
29	Carriage Bolt	910016
30	Lock Nut	910002
31	Washer	910015
32	Faucet Assembly	1000001
33	10-32 x 1" Machine Screw	910020
34	Dual Function Sprayer Set	1000207
35	Main Spa Electrical Control Box	1000302

Description

Part Number

36	Jet Box Cable*	1000303
37	Faceplate	2000007
38	6-18 1/2" Pan Screw	910021
39	Single Function Jet Control Button	1000300
40	Vinyl Screw Cap	1000100
41	Self-Tapping Screw	910023
42	Anchor Decal	1000153
43	Basin Support Gasket (Self-Adhesive)	1000224
44	#6 x 1" Drywall Screw	910019
45	Rotomold Base	2000101
46	Frontplate Decal	1000151

*Item #36 not shown

Luna Spa Technician Controls

- 1 Basin fill line
- 2 Sprayer/Fill Spout
- 3 Purely Simple Water Movement Assembly
- 4 Adjustable client leg support
- 5 On/Off button
- 6 Drain pop-up
- 7 Water control handle
- 8 Indicator Light
- 9 Drain pop-up knob

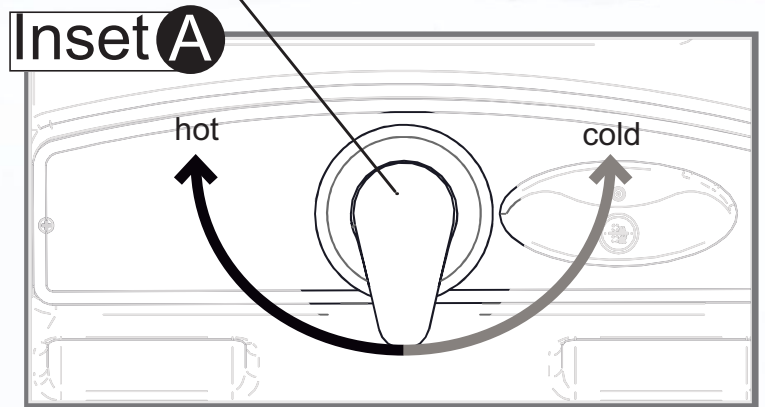
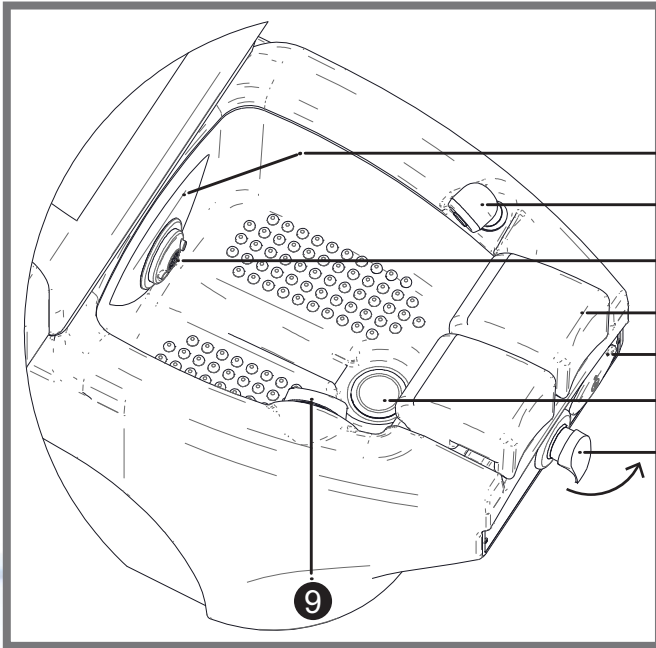

For Spas Equipped with Power Drain Pump

- 8 On/Off indicator light
- 9 On/Off button
- 10 Power Drain Pump On/Off button
- 11 Power Drain Pump indicator light

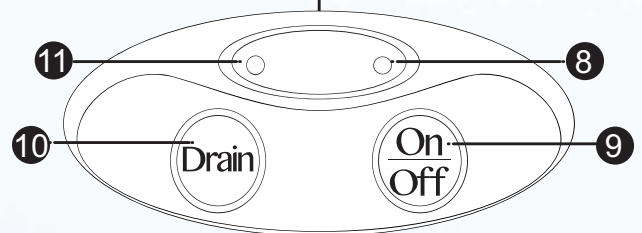
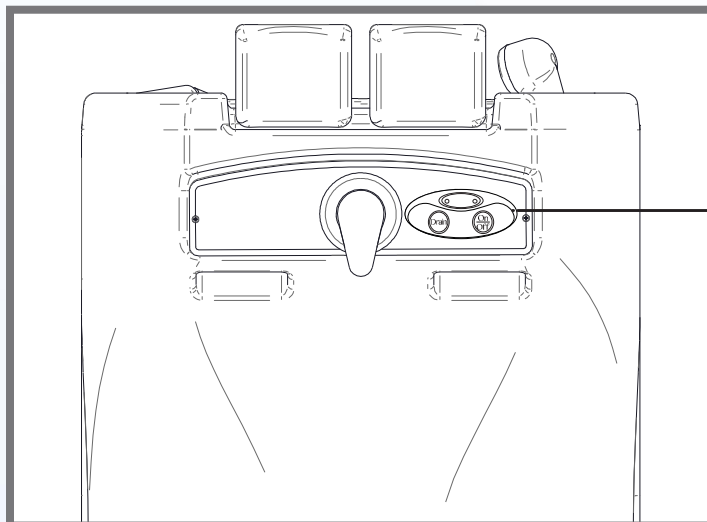

Basic use of your Luna Spa

Pull Water control handle (7 on previous page) on the front of the pedicure spa up to begin water fill. Use this handle to adjust water temperature.

- Rotate handle to the left for hot water.
- Rotate handle to the right for cold water.

See Inset A for more detail.

Close drain by turning the Drain Pop-Up Knob located on the left side of the inside of the basin. (9 on previous page.) Drain Pop-Up, 6 will close.

Water begins flowing from the sprayer/faucet, 2.

When basin fills to water fill line, 1, turn water off by pushing faucet control in towards spa.

Press On/Off button, 5 one time to begin Purely Simple Water Movement. Indicator light, 8 illuminates to show Water Movement is on. Water movement is powered by the Purely Simple Water Movement Assembly located at the back of the basin 3.

Press On/Off button again to turn water movement off.

To empty basin at the end of pedicure service, turn Drain Pop-Up knob the other direction to open Drain Pop-Up.

For Spas Equipped with Power Drain Pump

Follow directions above. When equipped with Power Drain Pump, press Drain Button, 10 one time to begin draining basin. An indicator light will illuminate, 11 and water will leave the basin via the drain located at the bottom of the basin. You will hear the sound of the Power Drain Pump while it is on. Press the button again to turn off Power Drain Pump when basin has been emptied of water. Power Drain Pump will disengage and the light will turn off.

If Power Drain Pump is not manually turned off, it will automatically turn off after 3 minutes.

Client Controls

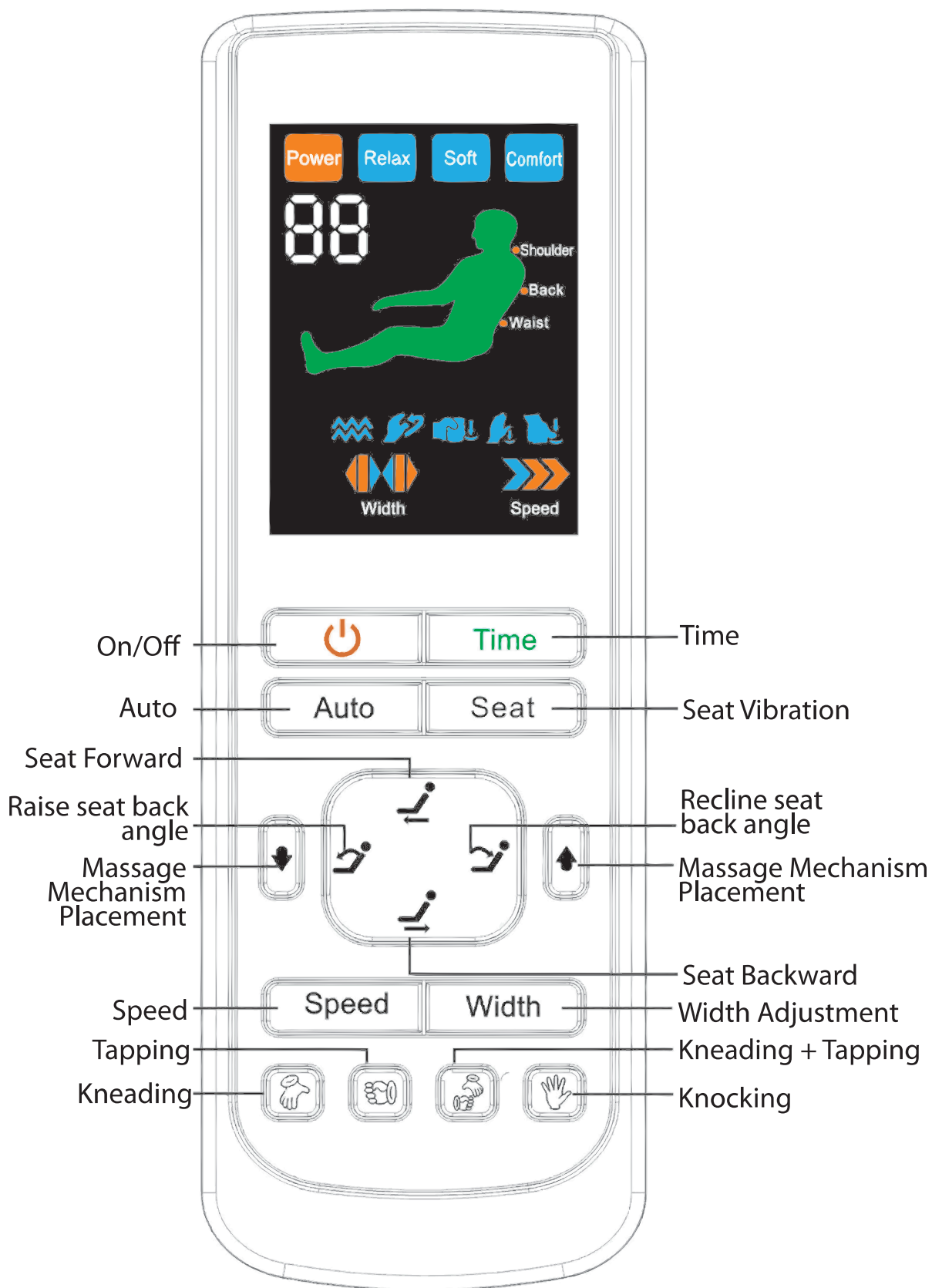

Client Controls



On/Off: In standby mode, press On/Off key to start auto/manual body massage, default setting time is 20 minutes (when time is up, the massage mechanism will stop working and move to lower backrest area).

Press On/Off key, the chair enters "turning off" status, the massage mechanism will move to the bottom of the backrest, LCD screen shows 00 which means Turning Off.

Time

Default setting time when turning on is 20 minutes. press "TIME" key again, the screen shows 10-20-30 minutes. After time is set, the screen shows every minute of diminishing time until 00 is reached, which means Turning Off.

Auto

Press AUTO key, the massage mechanism will start auto massage or stop auto massage. Three modes under auto status: relax - soft - comfort. Indicators on the screen illuminate accordingly.

Seat

Press this key to start seat vibration function. Press again, the vibration will stop. When vibration is on, the control will illuminate accordingly.



Hold this key in, the seat will move forward until foremost position is reached. Release the key, the movement stops.



Hold this key in, the seat will move backward until backmost position is reached. Release the key, the movement stops.



Hold this key in, the back rest will sit up until maximum incline is reached. Release the key, the backrest stops movement



Hold this key in, the back rest will recline until maximum reclination is reached. Release the key, the backrest stops movement.



Using "Manual Mode," during rolling or fixed point, press this key, the massage mechanism will move up. Release this key, the massage mechanism stops movement. This key has no response under Auto Mode.



Using "Manual Mode," during rolling or fixed point, press this key, the massage mechanism will move down. Release this key, the massage mechanism stops movement. This key has no response under Auto Mode.

Speed

Using "Manual Mode," during kneading, tapping + kneading and knocking, press this key to adjust massage speed from slow - medium - fast. Indicator on the remote's LCD screen will illuminate accordingly. This key has no response under Auto Mode.

Width

Using "Manual Mode," during tapping, rolling + tapping, press this key to adjust width between two rollers from narrow - medium - wide. Indicator on the remote's LCD screen will illuminate accordingly. This key has no response under Auto Mode.



Press kneading key, the massage mechanism will begin kneading massage. Indicator on the remote's LCD screen will illuminate accordingly.



Press kneading + tapping key, the massage mechanism with start kneading and tapping massage. Indicator on remote's LCD screen will illuminate accordingly.



Press Tapping key, the massage mechanism will begin Tapping massage. Indicator on remote's LCD screen will illuminate accordingly.



Press Knocking key, the massage mechanism will being Knocking massage. The indicator on remote's LCD screen will illuminate accordingly.

After Each Client:

1. **Drain** the water from the foot spa basin and remove any visible debris.
2. **Clean** the surfaces of the foot spa with soap or detergent, rinse with clean water, and drain.
3. **After cleaning**, disinfect the surfaces with an EPA-registered hospital disinfectant according to the manufacturer's directions on the label. Surfaces must remain wet with the disinfectant for 10 minutes or the time stated on the label, which may be shorter.
4. It is best to **disinfect** by filling the basin with clean water, adding the appropriate amount of liquid disinfectant, and turning the unit on to circulate the disinfectant for the entire contact time.
5. After disinfection, drain and **rinse** with clean water.

Nightly:

1. **Remove** the impeller cover by gently turning it counterclockwise.
2. **Remove** the impeller by unscrewing the retainer screw clockwise.
3. **Clean** out any debris trapped behind and around the cover and impeller.
4. Using a brush, **scrub** these parts with soap or disinfectant (following cleaning directions).
5. **Rinse** the removed parts with clean water and place them back into the basin apparatus.
6. **Fill** the basin with clean water and add an EPA-registered hospital disinfectant, following label directions. Turn the unit on and circulate the system with the liquid for 10 minutes, or the label-indicated time if different. (The water movement must be operating for the entire disinfection period so the components that contain hidden bacteria are disinfected.)
7. **After** disinfection, drain, rinse, and air dry.

At Least Once a Week:

1. **Do not drain** the disinfectant solution - Turn off the unit and leave the disinfecting solution in the unit overnight.
2. In the morning **drain**, **rinse** and **wipe dry** with a clean paper towel.

ADDITIONAL INFORMATION

1. All bottles and containers (other than the original manufacturers' container) containing any disinfectant must be properly labeled listing the contents, percentage solution (concentration) and date of mixing.
2. All brushes used to remove visible debris from the foot spa, tub or basin must be properly cleaned and disinfected between each use.
3. You must record the time of each cleaning procedure in the salon pedicure cleaning log. It demonstrates that you regularly clean and disinfect your pedicure equipment to ensure the customer is protected. A patron or state board representative may request to see your pedicure spa cleaning log.
4. Read and follow these instructions provided with the pedicure equipment to ensure proper use.

It is your responsibility to understand and follow your state's regulations regarding product cleaning and disinfecting requirements.

Because there are so many different products on the market, it is difficult for us to list all of the pedicure products that are safe to use in our pedicure spas. However, the following guidelines can be used:

- Do not use any products containing a foaming agent; this will cause excessive foam.
- It has been determined that products containing non-dissolving abrasives (such as sand and sea salts) will not harm the internal component structure of your pedicure spa as long as the entire Fusion Spas cleaning recommendations are followed without deviation.
- Oil based products may be used in your pedicure spa as long as the cleaning requirements are met.
- Always use pedicure products and cleaning solutions in accordance with each manufacturer's directions.
- It is your responsibility to understand and follow your state's regulations regarding product usage and disinfecting requirements.

It is the responsibility of the pedicure spa owner to properly clean and maintain the pedicure spa. If you are experiencing problems cleaning your pedicure spa, please contact the manufacturer of your pedicure products or Fusion Spas' Technical Support at 888-815-7757.

FUSION SPAS - LIMITED CONDITIONAL WARRANTY

Fusion Spas conditionally warrants your pedicure spa in accordance with the terms and conditions set forth below for a period of:

- three (3) years – Basin
- two (2) years – All other components

commencing on the original date of shipment of the Pedicure Spa to you. The warranty only applies to the Pedicure Spa's original end-user owner or customer (the "Customer"). Parts subject to normal wear and replacement including but not limited to drain handles and jet motor impeller covers are excluded.

This Conditional Warranty is non-transferable and replaces any warranties previously published by Fusion Spas.

If examination of the Pedicure Spa by Fusion Spas during the applicable warranty period shows it to have a defect in material or workmanship, Fusion Spas will, at its option, repair or replace the defective component or part thereof. Further, Fusion Spas may, at its discretion, replace a defective component or part with a refurbished component or part, or may replace the Pedicure Spa with a refurbished pedicure spa. If Fusion Spas elects to replace the Pedicure Spa, the replacement pedicure spa must be comparable in style and size to the Pedicure Spa. The Customer shall bear all charges incurred for the shipment to it of replacement components or parts, or a replacement pedicure spa, and the cost of all labor incurred in repairing defects in the Pedicure Spa or repairing or replacing any of its defective components or parts.

The foregoing limited warranty does not apply:

- To the Pedicure Spa, or any components or parts thereof, if subjected to misuse or neglect or if accidentally or intentionally damaged.
- To the Pedicure Spa, or any components or part, if altered or modified in any way.
- To any expenses incurred by the Customer or any third party, including labor or material, during investigation, removal or reinstallation of the Pedicure Spa or any defective components or parts.
- To any damage to or impairment of the Pedicure Spa, or any components or parts thereof, caused by any casualty, including without limitation, accident, fire, wind, floods, acts of nature or attempted theft.
- To any workmanship of a fabricator (other than Fusion Spas) or installer of the Pedicure Spa.
- If damage to pump parts and/or motor parts is due to obstructed plumbing.
- If the Pedicure Spa is removed from its place of initial installation.
- To staining, fading, or discoloration of any portion of the Pedicure Spa caused by water additives or improper water treatment.
- To staining, fading or discoloration of the Pedicure Spa's upholstered seat, armrests or footrests.
- To malfunctions or damage caused by improper installation of the Pedicure Spa, including, but not limited to, failure to meet local, state, or local plumbing, electrical and building codes.
- To damage resulting from a person standing in the Pedicure Spa's basin or other similar stress to that basin.
- To freight damage.
- To damage incurred to the Pedicure Spa while in possession of any party other than Fusion Spas.

This foregoing conditional limited warranty is also conditional upon:

- The Pedicure Spa being installed by a licensed professional in accordance with Fusion Spas installation instructions.
- The proper use of cleaning and sanitizing solutions in accordance with the manufacturer's instructions, or state board. It must be noted that repeated use of concentrated sodium hypochlorite

FUSION SPAS - LIMITED CONDITIONAL WARRANTY

- solutions (chlorine bleach), concentrated ether solutions, or acetone will damage chrome and plumbing components and will void the limited warranty on those parts. Fusion Spas recommends that you thoroughly read labels and use sanitizing products void of these chemicals.
- Use of this pedicure spa for functions it was not created for, including, but not limited to, ionic detox or any process that operates by reverse electroplating; this use will destroy plated parts and void the warranty.
- Shipment, if requested, to Fusion Spas of Pedicure Spa parts or components thought to be defective. Parts or components may only be returned if authorized in advance by Fusion Spa. All returns must be freight prepaid.
- Determination by Fusion Spas, in its reasonable discretion, that there exists a defect in material or workmanship.

Repair or replacement of any part or component under this Limited Warranty, or furnishing a replacement pedicure spa, shall not extend the duration of the warranty with respect to such repaired or replaced part beyond the stated warranty period. When a part or component is replaced, it will be under warranty for 90 days, or for the remaining life of original warranty, whichever period is greater.

Customer agrees by using the Pedicure Spa that

- THE OBLIGATION OF FUSION SPAS SHALL NOT EXTEND TO INDIRECT OR CONSEQUENTIAL DAMAGES OR INJURY WHICH MAY RESULT FROM SUCH USE
- that the obligations of Fusion Spas are limited to those set forth herein
- this warranty is limited to the original owner/end-user and is non-transferable
- Fusion Spas shall not be liable for any other obligations or liabilities, including, but not limited to: obligations or liabilities arising out of breach of contract or warranty, negligence, or other tort or any theory of strict liability with respect to the Pedicure Spa or parts or components thereof or any acts or omissions of Fusion Spas.
- Any assistance Fusion Spas provides to the Customer outside of terms, limitations, or exclusions of this limited warranty will not constitute a waiver of any of the foregoing terms, limitations, or exclusions, nor will such assistance extend or revive the warranty.

THIS LIMITED WARRANTY IS IN LIEU OF ALL OTHER WARRANTIES, EITHER EXPRESS OR IMPLIED, AND ALL SUCH OTHER WARRANTIES, INCLUDING WITHOUT LIMITATION, IMPLIED WARRANTIES OF MERCHANTABILITY OR FITNESS FOR A PARTICULAR PURPOSE, ARE HEREBY DISCLAIMED AND EXCLUDED FROM THIS LIMITED WARRANTY. NO DEALER OR OTHER PERSON HAS ANY AUTHORITY TO BIND FUSION SPAS TO CHANGES OR ADDITIONS TO THIS WARRANTY OR ITS PRODUCTS. ACCORDINGLY, FUSION SPAS IS NOT RESPONSIBLE FOR ANY SUCH OUTSIDE WARRANTIES OR REPRESENTATIONS.

IN NO EVENT SHALL FUSION SPAS BE LIABLE IN ANY WAY FOR ANY CONSEQUENTIAL, SPECIAL, OR INCIDENTAL DAMAGES OF ANY NATURE WHATSOEVER, OR FOR ANY AMOUNTS IN EXCESS OF THE SELLING PRICE OF THE PEDICURE SPA OR ANY COMPONENTS OR PARTS THEREOF FOUND TO BE DEFECTIVE. THIS LIMITED WARRANTY GIVES THE CUSTOMER SPECIFIC LEGAL RIGHTS. THE CUSTOMER MAY ALSO HAVE OTHER RIGHTS WHICH MAY VARY BY EACH JURISDICTION.

Should your Pedicure Spa require service due to a defect or malfunction, please contact:

Fusion Spas – Technical Support
888.815.7757 | 414.377.0222 | f: 414.755.5813
email: info@myfusionspa.com | www.myfusionspa.com

Cleaning Log

[illegible]

[illegible]